

# User Guide

## Basic Dimmer

Item NO.: D601R2

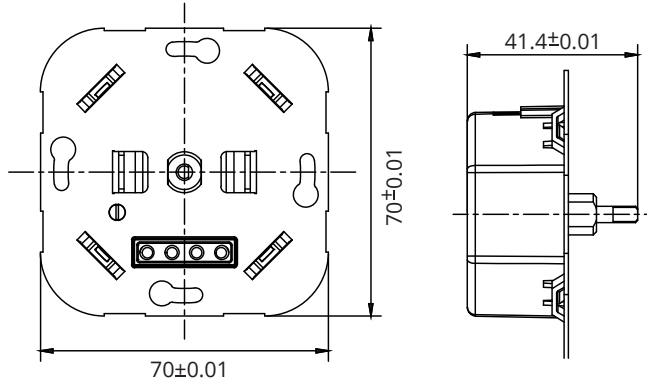

- ① Min. brightness adjustable
- ② Max. brightness self-adjust
- ③ Soft start protection
- ④ No neutral required
- ⑤ Turn-off memory
- ⑥ Recoverable type OT & OL protection

### 1. Technical Data

Model No.	D601R2
Description	Basic Dimmer
Input Voltage	220-240V
Input frequency	50Hz
Load	LED RC: 5-300W Incandescent RL: 5-150W Halogen
Dimming mode	Trailing Edge & Leading Edge
Control Way	Two way
Material	Heatsink Aluminum Bottom Case PC
Color	White
Weight(g)	49.3
Operating temperature	-10°C ~ +40°C
Dimension(mm)	70*70*41.4mm

### 2. Dimmer wiring diagram

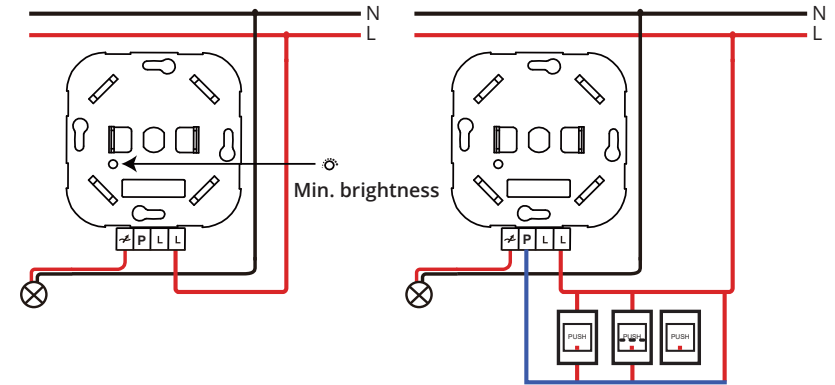

### 3. Operation and

Trun on/off	Press knob to turn ON I OFE
Dimming function	Turn the knob to the right to increase the brightness to the maximum value. Turn the knob to the left to reduce the brightness to minimum.
Setting the minimum Brightness	1. After installation turn on the device. 2. Clock wise the minimum switch to increase the light intensity. 3. Anticlock wise the minimum switch to decrease the light intensity
Over-temperature protection	integrated thermal protection circuit. At a dimmer internal temperature of 110° c The over-temperature protection is triggered and remains activated until the temperature reaches approximately 75° C has dropped. If this happens more often, please reduce the load.
Over-load protection	When connecting load has exceed 500W, The overload protection will be activated. Please reduce the connecting load and restart the device.

### 4. WARNING

- a. Installation must be carried by a qualified electrician.
- b. Before installation, please check whether it conforms to local electric standards
- c. Power supply must be turn off when install and clean the dimmer.  
Wipe the surface dust or dirt with soft cloth or tissue, do not use the detergent or other corrosive chemical solution.
- d. Please place and protect the cover properly when it' s in installation to avoid the damage.
- e. There is no strong impact, vibration, electromagnetic field interference, corrosion, or dusty gas around the usage environment
- f. The product should avoid frost, condensation, water seepage, rain, etc.