

# User Guide

## Multiway Dimmer

Item NO.: D669E2-MP

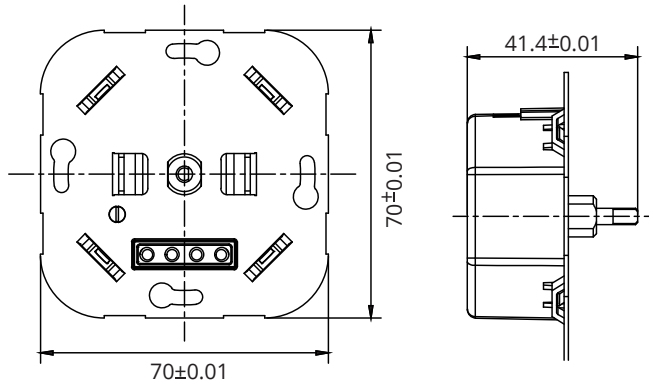

- ① Min. brightness adjustable
- ② Max. brightness self-adjust
- ③ Soft start protection
- ④ No neutral required
- ⑤ Turn-off memory
- ⑥ Recoverable type OT & OL protection

## 1. Technical Data

Model No.	D669E2-MP	
Description	Multiway Dimmer	
Input Voltage	220-240V	
Input frequency	50Hz	
Load	LED	5-250W
	Incandescent	5-300W
	Halogen	5-300W
Dimming mode	Trailing edge	
Control Way	Multiway	
Material	Heatsink	Aluminum
	Bottom Case	PC
Color	White	
Weight(g)	46.8	
Dimension(mm)	70*70*41.4mm	

## 2. Dimmer wiring diagram

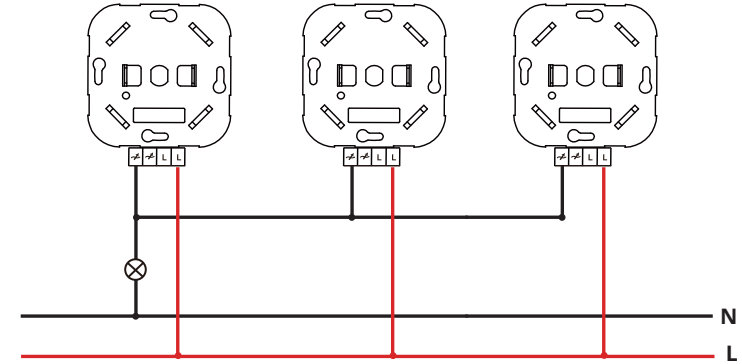

## 3. INSTALLATION:

1. Make sure the electricity is switched off before any operation, connect the wire as shown in the "wire connection".
2. Install the dimmer into the junction box.
3. Switch on electricity, push shaft button to ON or OFF, turn the shaft to dimming brightness. When lamps are flashing, adjust the min setting to the minimum brightness level. make lamps stable.
4. When all settings are finished, you can fit the dimmer in the wall. Cover the frame and the dimmer knob on the dimmer

\*If the dimmer is overloaded and gets too hot, the dimmer will start the protection function, so the dimmer will stop working. When you solve the issue, 5 minutes later push the rotary to reset the dimmer, dimmer will then work well again

### LEDVION DIMMER:

This RC dimmer has been developed specially for dimmable LED lamps. Additionally, the minimum brightness setting of the dimmer can be adjusted to achieve the optimum dimming range for a particular load. You may need to refer to these instructions if you change your lights to a different type at a later date so please keep them for reference.

\* NOTE: When using high quality LED drivers with low inrush currents

### WARNING!

Certain light sources may not behave according to their power rating when used with a dimmer. An overload will result in the safety feature switching the dimmer off. We always recommend to connect under the suggest load.

## 4. INSTALLATION INSTRUCTIONS:

### **Attention**

Installation should only be done by persons with electro technical knowledge and experience. These products are not suitable for installation at locations near the sea or in other environments with a corrosive atmosphere.

1. Ensure that the main power source is turned off.
2. Connect the device to the mains supply with the terminal block.
3. Make sure that the cables are connected securely to the terminals on the device.
4. When installation is finished, activate the power source and test the function.