

User Guide

Universal LED Dimmer Item NO.: D602E2

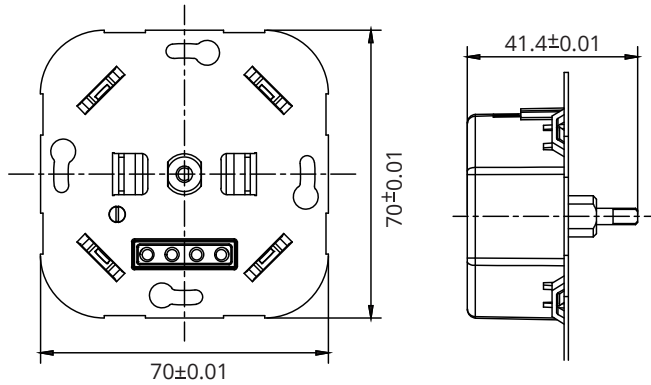

- ① Min. brightness adjustable
- ② Max. brightness self-adjust
- ③ Soft start protection
- ④ No neutral required
- ⑤ Turn-off memory
- ⑥ Recoverable type OT & OL protection

1. Technical Data

Model No.	D602E2	
Description	Universal LED Dimmer	
Input Voltage	220-240V	
Input frequency	50Hz	
Load	LED	5-300W
	Incandescent	10-300W
	Halogen	10-300W
Dimming mode	Trailing Edge	
Control Way	Multiway	
Material	Heatsink	Aluminum
	Bottom Case	PC
Color	White	
Weight(g)	47.1	
Operating temperature	-10℃ ~ +40℃	
Dimension(mm)	70*70*41.4mm	

2. Dimmer wiring diagram

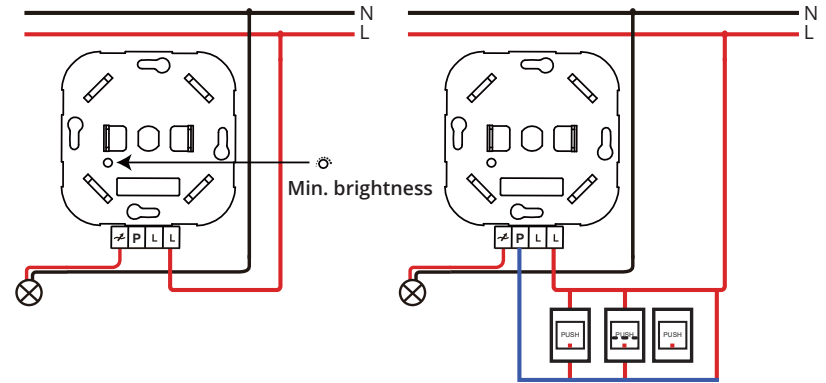

3. Features

Push Button Function	<ol style="list-style-type: none"> 1.Short press the push button to turn on or off the dimmer 2.Long press the push button to adjust the brightness of the lights
Minimum brightness adjustment	Adjust the potentiometer with a fine-tuning lever, decrease the brightness counterclockwise and increase the brightness clockwise.
Turn off the lights memory	<ol style="list-style-type: none"> 1.Turn on the dimmer and adjust it to any brightness level 2.After adjusting the brightness, turn off the dimmer and wait for two seconds before turning it back on

4. WARNING

- a. Installation must be carried by a qualified electrician.
- b. Before installation, please check whether it conforms to local electric standards
- c. Power supply must be turn off when install and clean the dimmer.
Wipe the surface dust or dirt with soft cloth or tissue, do not use the detergent or other corrosive chemical solution.
- d. Please place and protect the cover properly when it' s in installation to avoid the damage.
- e. There is no strong impact, vibration, electromagnetic field interference, corrosion, or dusty gas around the usage environment
- f. The product should avoid frost, condensation, water seepage, rain, etc.