

User Guide

POL LED Dimmer -Zigbee Item NO.: D689-ZG

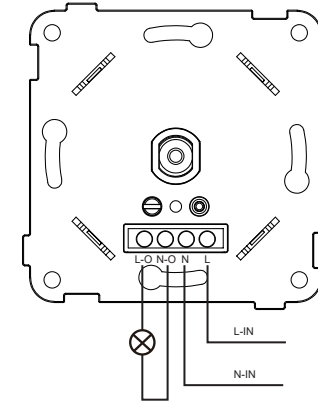

2. Dimmer wiring diagram

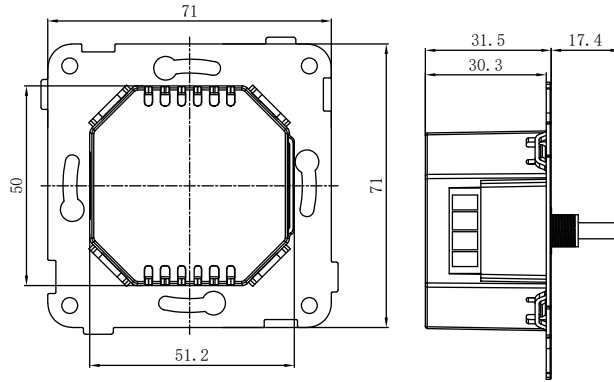

- ① Light off memory
- ② Over current protection
- ③ Over-temperaure protection
- ④ Short circuit protection

1. Technical Data

Model No.	D689-ZG
Description	2-POL LED Dimmer -Zigbee
Input Voltage	220-240V
Input frequency	50Hz
Load	LED 5-250W Incandescent 5-250W Halogen 5-250W
Dimming mode	Trailing Edge
Control Way	One way
Material	Heatsink Aluminum Bottom Case PC
Color	White
Weight(g)	71.6
Dimension(mm)	71*71*48.9mm

3. Operation and function

Turn on/off	Short press the push button to turn on or off
Dimming function	Rotate the knob clockwise to brighten and counterclockwise to dim
Minimum brightness fine-tuning setting	Adjust and fine tune with tools in the trun on state, Rotate clockwise for fine adjustment, and the brightness of the light gradually increases; Rotate counterclockwise to gradually reduce the brightness of the light
Reset	Press and hold the dimmer reset button for 10 seconds, the red indicator light will remain on for 5 seconds, indicating a successful reset
Mobile App control	<ol style="list-style-type: none"> Do wiring according to connection diagram correctly. This ZigBee device is a wireless receiver that communicates with a variety of ZigBee compatible systems. This receiver receives and is controlled by wireless radio signals from the compatible ZigBee system. Zigbee Network Pairing through Coordinator or Hub (Added to a Zigbee Network) <ol style="list-style-type: none"> Step 1: Remove the device from previous zigbee network ifit has already been added to, otherwise pairing wilfail Please refer to the part "Factory Reset Manually". Step 2: From your ZigBee Controller or hub interface, choose to add lighting device and enter Pairing mode asinstructed by the controller. Step 3: Double Press the reset button to activate the network paring modeThe blue indicator light is flashing).network pairing mode will last for15minutes once timeout repeat this step Step 4:The Blue indicator will stopflashing and solid on for 10s then the device will appear inyour controller's menu and canbe controlled through controlleror hub interface TouchLink to a Zigbee Remote <ol style="list-style-type: none"> Step 1:Short pressReset" button 4 times Step 2: The Green indicatorwill start flashing to show thatthe device is in touchlinkcommissioning.180s timeout repeat this step Step 3: Bring the remote or touchpanel within 10cm of the lightingdevice. Step 4: Set the remote or touchpanel into Touchlinkcommissioning.please refer to correspondngremote or touch panel manual to learn how. Step 5: The connecting lights will start flashing to indicate the pairing processing.Once paired both the connecting lights and the green indicator light will stop flashing and you can control the lights by the remote <p>Note :</p> <ol style="list-style-type: none"> 1) Directly Touchlink(both not added to a Zigbee network),each device can link with 1 remote. 2) Touchlink after both added to a Zigbee network, each device can link with max.30 remotes. 3) For Hue Bridge & Amazon Echo Plus , add remote and device to network first then Touchlink. 4) After Touchlink,the device can be controlled by the linked remotes. 6. Remove from a zigbee network. <p>Short press the reset button 3 times,the purple indicator light will flashing. The purple indicator will be stop flashing and solid on for 10s to show successful remove. 180S timeout repeat this step.</p>

Operation

1. Do wiring according to connection diagram correctly.
2. This ZigBee device is a wireless receiver that communicates with a variety of ZigBee compatible systems. This receiver receives and is controlled by wireless radio signals from the compatible ZigBee system.
3. Zigbee Network Pairing through Coordinator or Hub (Added to a Zigbee Network)

Step 1: Remove the device from previous zigbee network if it has already been added to, otherwise pairing will fail. Please refer to the part "Factory Reset Manually".

Step 2: From your ZigBee Controller or hub interface, choose to add lighting device and enter Pairing mode as instructed by the controller.

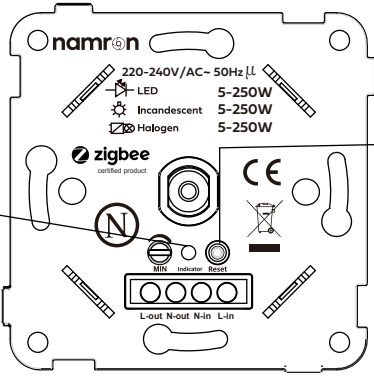

Step 4:

The Blue indicator will stop flashing and solid on for 10s then the device will appear in your controller's menu and can be controlled through controller or hub interface.

Step 3:

Double Press the reset button to activate the network pairing mode (The blue indicator light is flashing), network pairing mode will last for 15 minutes once timeout repeat this step.

4.TouchLink to a Zigbee Remote

Step 3: Bring the remote or touch panel within 10cm of the lighting device.

Step 4: Set the remote or touch panel into Touchlink commissioning. please refer to corresponding remote or touch panel manual to learn how.

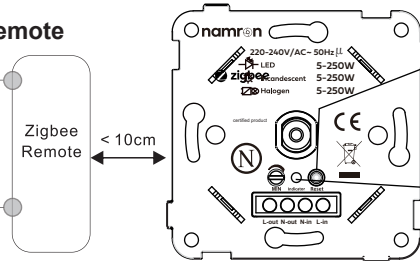

Step 1: Short press "Reset" button 4 times.

Step 2: The Green indicator will start flashing to show that the device is in touchlink commissioning. 180s timeout repeat this step.

Step 5: The connecting lights will start flashing to indicate the pairing processing.

Once paired both the connecting lights and the green indicator light will stop flashing and you can control the lights by the remote.

Note : 1) Directly Touchlink(both not added to a Zigbee network),each device can link with 1 remote.

- 2) Touchlink after both added to a Zigbee network, each device can link with max.30 remotes.
- 3) For Hue Bridge & Amazon Echo Plus , add remote and device to network first then Touchlink.
- 4) After Touchlink, the device can be controlled by the linked remotes.

6.Remove from a zigbee network.

Short press the reset button 3 times,the purple indicator light will flashing.

The purple indicator will be stop flashing and solid on for 10s to show successful remove.

180S timeout repeat this step.

6. Factory Reset Manually

Note: All configuration parameters will be reset after the device is reset or removed from the network.

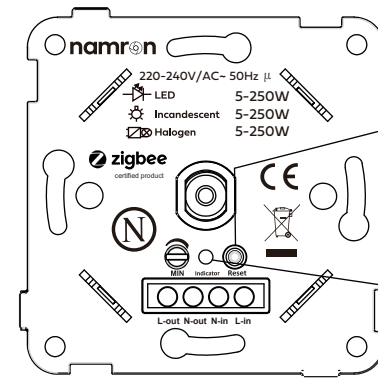

Step 1: Press and hold reset button for over 5 seconds.

Step 2: The Red indicator light will be on for 10s to show the device has been reset.

7. Find and Bind Mode

Note: Make sure the device and remote already added to the same zigbee network.

Step 3: Set the remote or touch panel (target node) into find and bind mode, and enable it to find and bind initiator, please refer to corresponding remote or touch panel manual.

Step 4: There shall be indication on the remote or touch panel that it bind the device successfully and can control it then to learn how.

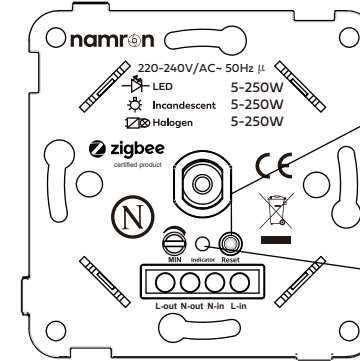

Step 1: Press the reset button 5 times.

Step 2: The yellow indicator will start flashing. 180s timeout repeat this step.

8. Setup a Zigbee Network & Add Other Devices to the Network(No Coordinator Required)

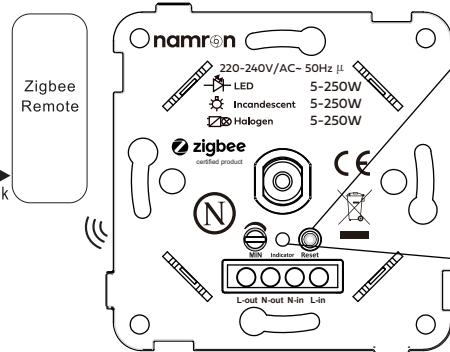
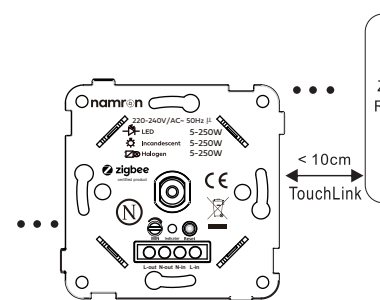

Step 1. Press the reset button for 6 times to enable the device to setup a zigbee network.

Step 2. The white indicator will start flashing and stay solid for 10s to show the dimmer has creating the zigbee network successfully.

Step 3 : Press the reset button for 7 times to allow other devices to be added into the network. The red indicator light will be flashing continuously.

Step 4 : Set another device or remote or touch panel into network pairing mode and pair to the network, refer to their manuals. 180s time limit.

Step 5 : Pair more devices and remotes to the network as you would like, refer to their manuals.

Step 6 : Bind the added devices and remotes through Touchlink so that the devices can be controlled by the remotes. refer to their manuals.

Note: 1) Each added device can link and be controlled by max.30 added remotes

2) Please refer to remote instruction of how many zigbees can be linked.

1.WARNING

- a. Installation must be carried by a qualified electrician.
- b. Before installation, please check whether it conforms to local electric standards
- c. Power supply must be turn off when install and clean the dimmer.
Wipe the surface dust or dirt with soft cloth or tissue, do not use the detergent or other corrosive chemical solution.
- d. Please place and protect the cover properly when it' s in installation to avoid the damage.
- e. There is no strong impact, vibration, electromagnetic field interference, corrosion, or dusty gas around the usage environment
- f. The product should avoid frost, condensation, water seepage, rain, etc.